

**Alvea.** Your future, our view.

The distinctive feature of our Smart Retail approach is the seamless integration between the digital world and the physical experience.

The boundaries between online and offline dissolve, allowing customers to explore, discover, and purchase products in an engaging and informative context. ALVEA is committed to providing a fully personalized experience.

Thanks to technology and data analysis, we can offer customers targeted suggestions and answers to their questions even before they are asked.

Our experts, always present in-store, will provide detailed information to guide customers in discovering all aspects of each individual product.



Interior wooden doors



Windows



Shading systems



Flooring and wall coverings

alvea

YOUR FUTURE OUR VIEW

alvea stores

MILAN

TURIN

ROME

FLORENCE

NAPLES

DOHA

DUBAI

RIYADH

alvea.it - info@alvea.it



flat line





## Casement doors and windows

### Maximum brightness:

The most performing Line characterized by the HES system, High Energy Saving, ideal system for those looking for an essential design, designed to obtain maximum brightness and transparency with excellent thermal and acoustic insulation performance.

The first full-aluminum window to achieve the prestigious Gold Class "Climate House Quality Window" certification.



### NC 65 STH HES

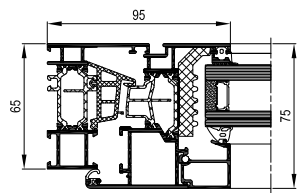

Telaio fisso Frame	Telaio mobile Sash	Spessore vetri Glass thickness
65 mm	75 mm	da 8 mm a 60 mm variabile in funzione della linea estetica depending on the aesthetic line
Trasmissione termica Thermal transmittance		
Valore Uf 1,2-2,3 W/m² K / Uf value 1,2-2,3 W/m² K (Finestra 1 ante 1230 x 1480 mm; vetro Ug 0,6 W/m² K, Psi 0,031 W/m² K) (Casement window 1230 x 1480 mm; glass Ug 0,6 W/m² K, Psi 0,031 W/m² K)		

### NC 75 STH HES

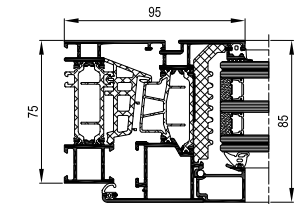

Telaio fisso Frame	Telaio mobile Sash	Spessore vetri Glass thickness
75 mm	85 mm	da 8 mm a 70 mm variabile in funzione della linea estetica depending on the aesthetic line
Trasmissione termica Thermal transmittance		
Valore Uf 1,0-2,1 W/m² K / Uf value 1,0-2,1 W/m² K (Finestra 1 ante 1230 x 1480 mm; vetro Ug 0,6 W/m² K, Psi 0,031 W/m² K) (Casement window 1230 x 1480 mm; glass Ug 0,6 W/m² K, Psi 0,031 W/m² K)		

### NC 90 STH HES

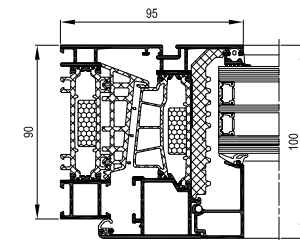

Telaio fisso Frame	Telaio mobile Sash	Spessore vetri Glass thickness
90 mm	100 mm	da 12 mm a 83 mm variabile in funzione della linea estetica depending on the aesthetic line
Trasmissione termica Thermal transmittance		
Valore Uf 0,84-1,8 W/m² K / Uf value 0,84-1,8 W/m² K (Finestra 1 ante 1230 x 1480 mm; vetro Ug 0,6 W/m² K, Psi 0,031 W/m² K) (Casement window 1230 x 1480 mm; glass Ug 0,6 W/m² K, Psi 0,031 W/m² K)		



## Sliding doors and windows

### Enhance spaces:

Thermal break, great resistance to atmospheric agents and high insulating performance. Flat Line consists of aluminum products suitable for medium-small sized sliding glass doors such as balconies or verandas or to cover small dimensions in unheated or cooled common areas.

Each type of habitat will be valued.

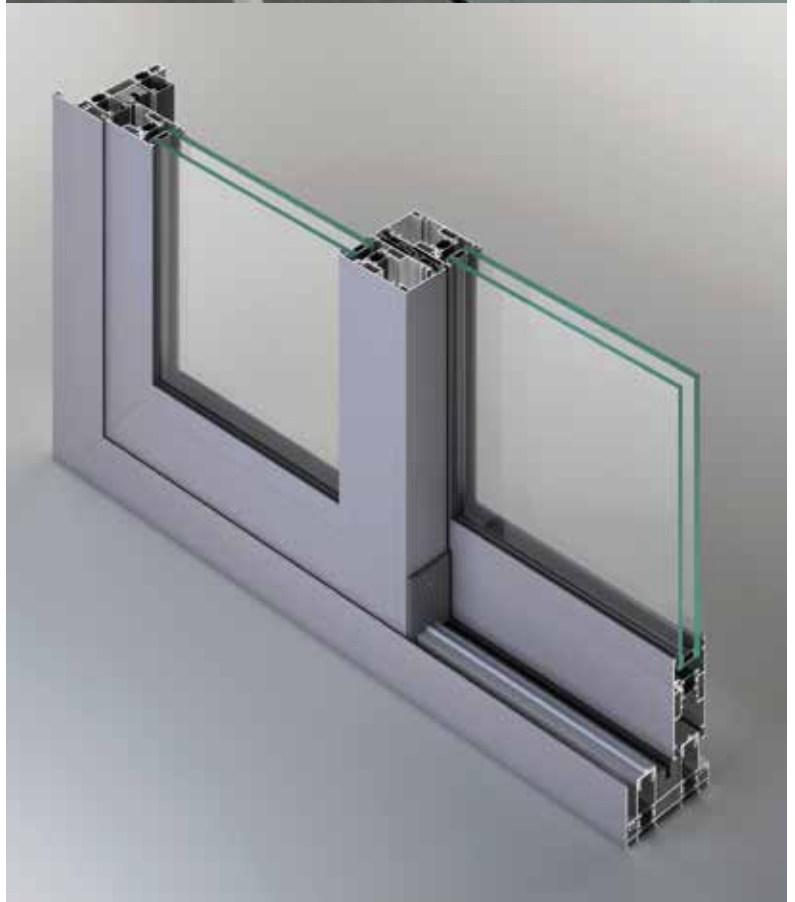

### NC-S 120

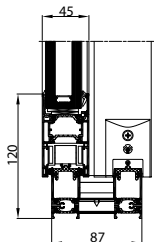

Telaio fisso Frame	Telaio mobile Sash	Spessore vetri Glass thickness	Peso massimo anta Maximum sash weight
87 mm	45 mm	termavetro: da 26 a 36 mm vetro ad infrarossi: da 33 a 37 mm	200 kg

Trasmissione termica Thermal transmittance		Valore Uf 2,7-3,9 W/m² K / Uf value 2,7-3,9 W/m² K (Finestra 3000x2700 mm; vetro Ug 1 W/m² K, Psi 0,036 W/m² K) (Casement window 3000x2700 mm; glass Ug 1 W/m² K, Psi 0,036 W/m² K)	
---	--	---	--

### NC-S 65 STH

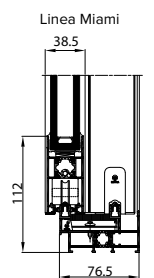
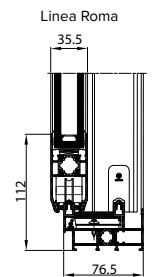

Telaio fisso Frame	Telaio mobile Sash	Spessore vetri Glass thickness	Peso massimo anta Maximum sash weight
58,5 mm 76,5 mm	Linea Roma: 35,5 mm Linea Miami: 38,5 mm	da 22 mm a 28 mm	130 kg

Trasmissione termica Thermal transmittance		Valore Uf 4,5-6,7 W/m² K / Uf value 4,5-6,7 W/m² K (Finestra 3000x2700 mm; vetro Ug 1 W/m² K, Psi 0,036 W/m² K) (Casement window 3000x2700 mm; glass Ug 1 W/m² K, Psi 0,036 W/m² K)	
---	--	---	--